

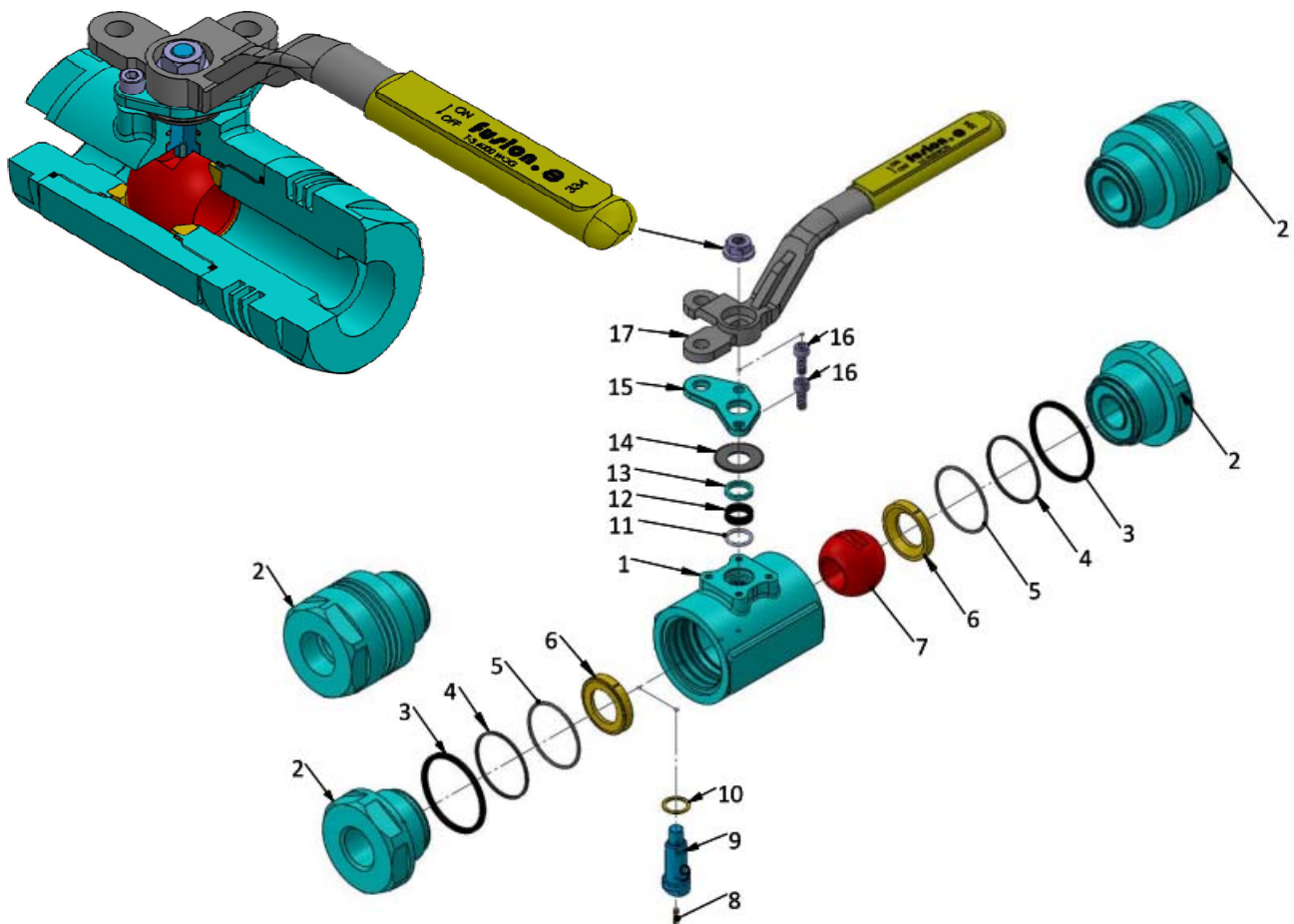

# Crown - fusion Series 334

- Threaded, Socket weld Three-piece ball valve
- High Pressure Ball Valve
- Full Port 1/4" ~ 2" sizes, Regular Port 3/4" ~ 3" sizes
- Threaded & Socket weld - 3000, 4000, 6000 WOG
- ASME B16.34 Standard
- Blowout Proof Stem
- Standard Welding "Fins" on Socket weld Valves
- Double Seal at Stem and Body Connections
- Material to NACE MR0175
- Standard Marking to MSS SP-25
- Fire Safe Certified to API 607
- Fugitive Emissions Certified to API 641
- Pressure Tests to API 598
- Standard Locking Handle
- Standard Anti-static Device
- 3000 WOG Seal Welded Tailpiece option- "HSBF"
- 4000 WOG Seal Welded Tailpiece option- "HYBF"
- 6000 WOG Seal Welded Tailpiece option- "HYBF"





# Crown - fusion Series 334

## Bill of Materials

ITEM	PART	STAINLESS STEEL	SOUR LOW TEMP (NACE)	SOUR (NACE)	Q'TY
1	BODY	ASTM A351 CF8M / ASTM A479 316	ASTM A350 LF2 / ASTM A352 LCC	ASTM A105 / A105N ASTM A216 WCB	1
2	END CAP	ASTM A479 316	ASTM A350 LF2	ASTM A105 / A105N	2
☆ 3	BODY GASKET	GRAPHITE	GRAPHITE	GRAPHITE	2
☆ 4	BACKUP RING	NITRILE	NITRILE	NITRILE	2
☆ 5	END CAP O-RING	TEFLON / HNBR	VITON GLT / HNBR	VITON / HNBR	2
☆ 6	SEAT	TFM / VIRGIN PEEK	TFM / VIRGIN PEEK	TFM / VIRGIN PEEK	2
7	BALL	ASTM A351 CF8M / A182 F316 / ASTM A564 630 H1150D	ASTM A351 CF8M / A182 F316 / ASTM A564 630 H1150D	ASTM A351 CF8M / A182 F316 / ASTM A564 630 H1150D	1
8	SPRING	304SS	304SS	304SS	1
9	STEM	ASTM A564 630 H1150D	ASTM A564 630 H1150D	ASTM A564 630 H1150D	1
☆ 10	THRUST WASHER	TFM / PEEK	TFM / PEEK	TFM / PEEK	1
☆ 11	STEM O-RING	VITON / HNBR	VITON GLT / HNBR	VITON / HNBR	1
☆ 12	PACKING	GRAPHITE	GRAPHITE	GRAPHITE	1
13	PACKING FOLLOW	304SS	304SS	304SS	1
14	BELLEVILLE WASHER	304SS	304SS	304SS	1
15	GLAND FLANGE	304SS	CS	CS	1
16	BOLT	ASTM A320 L7M PLATED	ASTM A320 L7M	ASTM A320 L7M	2
17	HANDLE	ASTM A351 CF8	CS	CS	1
18	HANDLE NUT	304SS	CS	CS	1

Note 1 : ☆ Minor repair kit :

Note 2 : ITEM 4 With 6000 WOG Only

Note 3 : (ITEM 6) RTFM for 3000 WOG , VIRGEN PEEK for 4000 and 6000 WOG

Note 4 : (ITEM 7) BALL Material ASTM A351 CF8M/A182 F316 for 3000 WOG , ASTM A564 630 H1150D for 4000 WOG and 6000 WOG

Note 5 : (ITEM 10) RTFM for 3000 WOG , PEEK for 4000 and 6000 WOG





# Crown - fusion Series 334

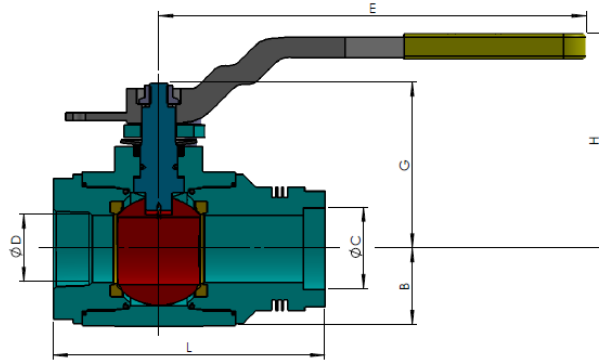

## Weights and Dimensions

SIZE	WOG	BORE	D	C	L			B	G	H	E	Cv	WEIGHT	
					In/mm	In/mm	NPT						SW	NPT X SW
In/DN					In/mm	In/mm	In/mm	In/mm	In/mm	In/mm	In/mm		Kg/Lbs	
1/4 /8	3000	FP	0.50/12.7	0.57/14.4	3.86/98	5.00/127	4.43/112	0.87/22	1.61/41	3.15/80	6.50/165	9	1.6/3.5	
	4000													
3/8 /10	3000	FP	0.50/12.7	0.70/17.7	3.86/98	5.00/127	4.43/112	0.87/22	1.61/41	3.15/80	6.50/165	9	1.6/3.5	
	4000													
1/2 /15	3000	FP	0.50/12.7	0.87/22.0	3.86/98	5.00/127	4.43/112	0.87/22	1.61/41	3.15/80	6.50/165	26	1.6/3.5	
	4000													
3/4 /20	3000	FP	0.75/19.0	1.08/27.4	4.25/108	6.73/171	5.49/140	1.08/28	2.25/57	3.67/93	8.07/205	61	2.4/5.3	
	4000													
	3000	RP	0.50/12.7	1.08/27.4	4.37/111	6.75/172	5.56/141	0.87/22	1.61/41	3.15/80	6.50/165	14	2.1/4.6	
	4000													
6000	FP	0.75/19.0	1.08/27.4	4.25/108	6.73/171	5.49/140	1.18/30	2.25/57	3.67/93	8.07/205	61	2.8/6.2		
6000												RP	0.50/12.7	1.08/27.4
1 /25	3000	FP	1.00/25.4	1.34/34.1	5.22/133	6.72/171	5.97/152	1.27/32	2.51/64	3.93/100	8.07/205			
	4000													
	3000	RP	0.75/19.0	1.34/34.1	4.25/108	6.75/171	5.49/140	0.87/22	2.25/57	3.67/93	8.07/205	25	2.9/6.4	
	4000													
6000	FP	1.00/25.4	1.34/34.1	5.38/137	6.72/171	5.97/152	1.40/36	2.51/64	3.93/100	8.07/205	110	4.7/10.3		
6000												RP	0.75/19.0	1.34/34.1
1-1/4 /32	3000	FP	1.50/38.0	1.69/42.9	6.26/159	8.54/217	7.40/188	2.00/51	3.56/91	5.30/135	10.04/255			
	4000													
	3000	RP	1.00/25.4	1.69/42.9	6.24/159	8.69/221	7.45/189	1.27/32	2.51/64	3.93/100	8.07/205	50	5.9/13.0	
	4000													
6000	FP	1.50/38.0	1.69/42.9	6.30/160	8.54/217	7.42/189	2.23/57	3.56/91	5.30/135	10.04/255	170	11.4/25.1		
6000												RP	1.00/25.4	1.69/42.9
1-1/2 /40	3000	FP	1.50/38.0	1.93/49.0	6.26/159	8.54/217	7.40/188	2.00/51	3.56/91	5.30/135	10.04/255			
	4000													
	3000	RP	1.00/25.4	1.93/49.0	6.40/163	8.69/221	7.54/192	1.27/32	2.51/64	3.93/100	8.07/205	38	5.8/12.8	
	4000													
6000	FP	1.50/38.0	1.93/49.0	6.30/160	8.54/217	7.40/188	2.23/57	3.56/91	5.30/135	10.04/255	260	11.2/24.6		
6000												RP	1.00/25.4	1.93/49.0
2 /50	3000	FP	2.00/50.8	2.42/61.4	6.26/159	9.84/250	8.05/205	2.54/65	4.92/125	6.30/160	12.40/315			
	4000													
	3000	RP	1.50/38.0	2.42/61.4	6.26/159	8.54/217	7.40/188	2.00/51	3.56/91	5.30/135	10.04/255	100	9.5/20.9	
	4000													
6000	FP	2.00/50.8	2.42/61.4	6.26/159	9.84/250	8.05/205	2.84/72	4.92/125	6.30/160	12.40/315	480	18.0/39.6		
6000												RP	1.50/38.0	2.42/61.4
3 /80	3000	RP	2.00/50.8	3.54/90.0	10.00/254	12.76/324	11.38/289	2.54/65	4.92/125	6.30/160	12.40/315			
	4000													
6000	RP	2.00/50.8	3.54/90.0	10.28/261	12.76/324	11.52/292	2.84/72	4.92/125	6.30/160	12.40/315	350	24.3/53.6		

Note 1 : "L" DIMENSION ± 0.06 in. /1.5 mm  
 Note 2 : "B" DIMENSION FOR FORGING BODY





# Crown - fusion Series 334

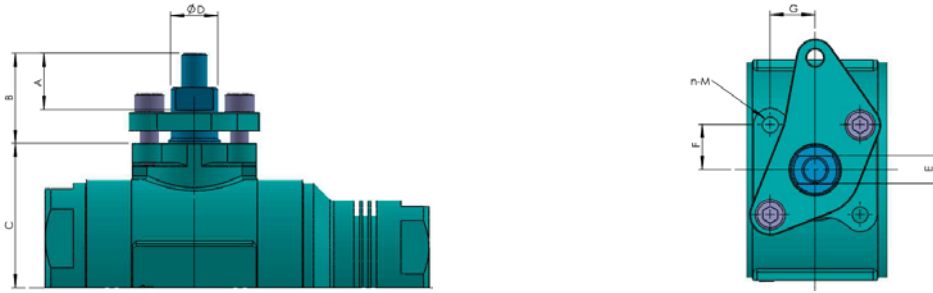

Actuator Mounting Dimensions

SIZE	BORE	A	B	C	D	E(FLAT)	F	G	n-M
In/DN		In/mm	In/mm	In/mm	In/mm	In/mm	In/mm	In/mm	mm
1/4 /8	FP	0.43/11	0.63/16	0.98/25	0.47/12	0.26/6.5	0.47/12	0.47/12	4-M5X9 DEEP
3/8 /10	FP	0.43/11	0.63/16	0.98/25	0.47/12	0.26/6.5	0.47/12	0.47/12	4-M5X9 DEEP
1/2 /15	FP	0.43/11	0.63/16	0.98/25	0.47/12	0.26/6.5	0.47/12	0.47/12	4-M5X9 DEEP
3/4 /20	FP	0.55/14	0.83/21	1.42/36	0.47/12	0.33/8.5	0.47/12	0.47/12	4-M5X9 DEEP
	RP	0.43/11	0.63/16	0.98/25	0.47/12	0.26/6.5	0.47/12	0.47/12	4-M5X9 DEEP
1 /25	FP	0.55/14	0.85/22	1.65/42	0.47/12	0.33/8.5	0.47/12	0.47/12	4-M5X9 DEEP
	RP	0.55/14	0.83/21	1.42/36	0.47/12	0.33/8.5	0.47/12	0.47/12	4-M5X9 DEEP
1-1/4 /32	FP	0.83/21	2.78/71	2.24/57	0.75/20	0.43/11	0.79/20	0.79/20	4-M8X10 DEEP
	RP	0.55/14	0.83/21	1.65/42	0.47/12	0.33/8.5	0.47/12	0.47/12	4-M5X9 DEEP
1-1/2 /40	FP	0.83/21	2.78/71	2.24/57	0.75/20	0.43/11	0.79/20	0.79/20	4-M8X10 DEEP
	RP	0.55/14	0.83/21	1.65/42	0.47/12	0.33/8.5	0.47/12	0.47/12	4-M5X9 DEEP
2 /50	FP	1.18/30	1.89/48	3.03/77	1.00/25	0.59/15	0.94/24	0.94/24	4-M10X15 DEEP
	RP	0.83/21	2.78/71	2.24/57	0.75/20	0.43/11	0.79/20	0.79/20	4-M8X10 DEEP
3 /80	RP	1.18/30	1.89/48	3.03/77	1.00/25	0.59/15	0.94/24	0.94/24	4-M10X15 DEE

## PRESSURE/TEMPERATURE CURVE

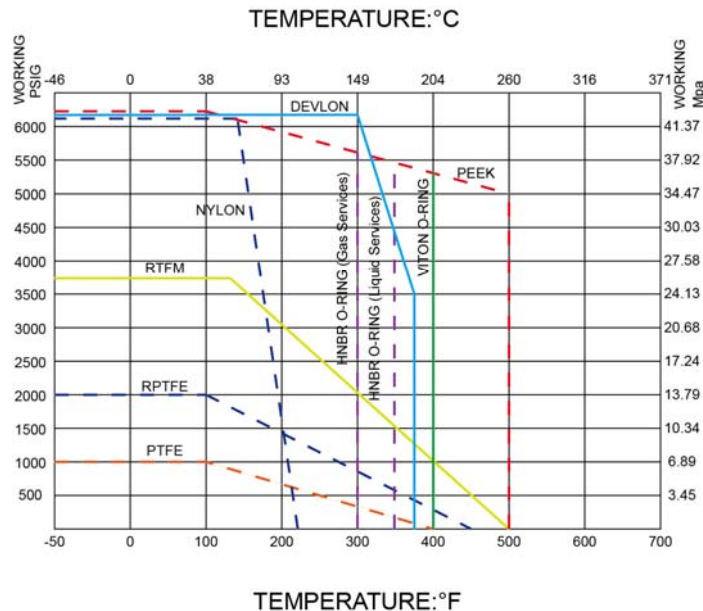

## TORQUE DATA

Torque Data is published separately and available upon request. Please contact your local representative for details.

Due to continuous development of our products, we reserve the right to modify our product design or construction without prior notice.

