



Crown - fusion Series 311

Raised Face Flanged Unibody, Regular Port Ball Valve

3/4" - 8" size, ASME Class 150/300

API 6D Monogrammed

Fire safe Certified to API 607

Fugitive Emissions Certified to API 641

Standard ISO 5211 Mounting Pad

API 608 Compliance

Standard Locking Handle

Double Seal at Stem and Seat Retainer

Standard Anti-Static Device

Material to NACE MR0175 / ISO 15156

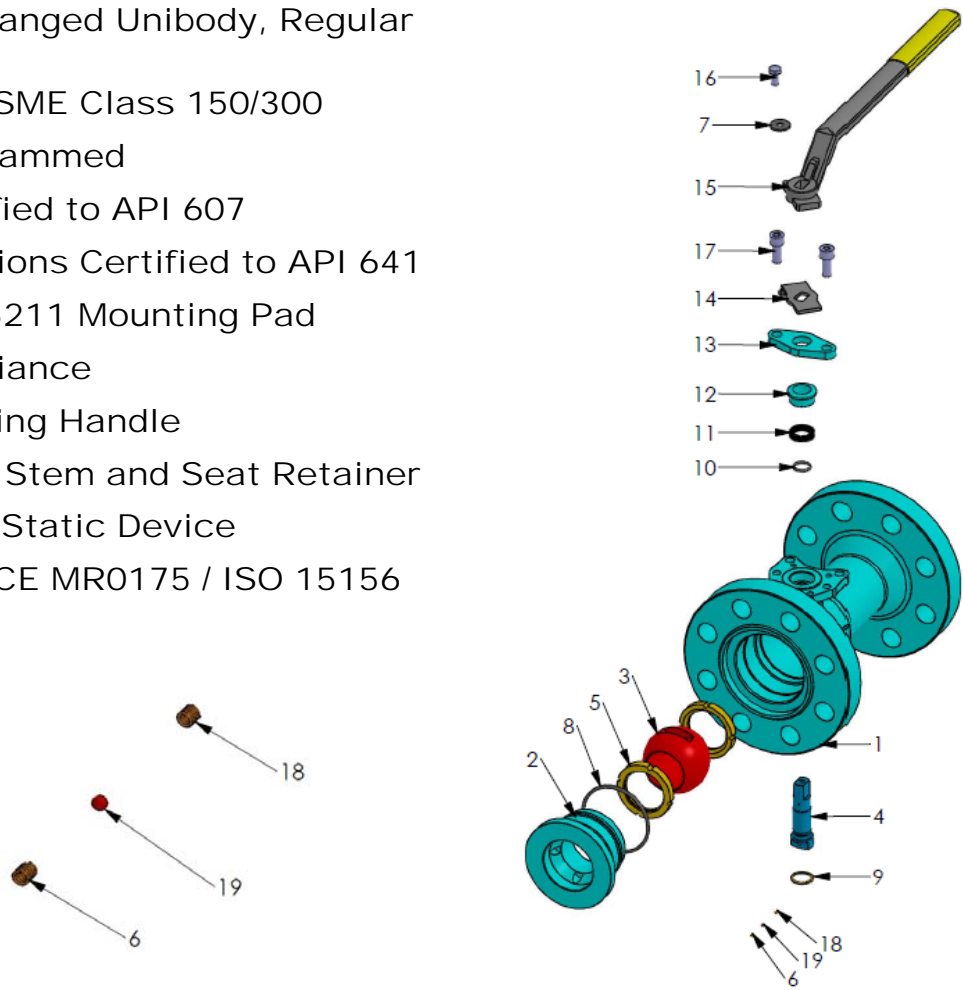

Bill of Materials:

ITEM	PART	STAINLESS STEEL	SOUR LOW TEMP (NACE)	SOUR (NACE)
1	BODY	ASTM A351 CF8M	ASTM A352 LCC	ASTM A216 WCB
2	SEAT RETAINER	ASTM A479 316	ASTM A350 LF2	ASTM A105N
3	BALL	ASTM A351 CF8M /A182 F316	ASTM A351 CF8M /A182 F316	ASTM A351 CF8M /A182 F316
4	STEM	A564 630 H1150D	A564 630 H1150D	A564 630 H1150D
☆5	SEAT	TFM	TFM	TFM
6	SPRING	304SS	304SS	304SS
7	PLAIN WASHER	304SS	C/S	C/S
☆8	BODY O-RING	VITON / HNBR	VITON GLT / HNBR	VITON / HNBR
☆9	THRUST WASHER	TFM	TFM	TFM
☆10	STEM O-RING	VITON / HNBR	VITON GLT / HNBR	VITON / HNBR
☆11	PACKING	GRAPHITE	GRAPHITE	GRAPHITE
12	GLAND	304SS	CS	CS
13	GLAND FLANGE	ASTM A351 CF8	CS	CS
14	STOPPER	304SS	CS	CS
15	HANDLE	ASTM A351 CF8	CS	CS
16	HANDLE NUT / BOLT	304SS	CS	CS
17	CAP SCREWS	A320 L7M WITH ZINC PLATING	ASTM A320 L7M	ASTM A320 L7M
18	SPRING	304SS	304SS	304SS
19	ANTISTATIC BALL	304SS	304SS	304SS

Note: ☆ Minor repair kit;





Crown - fusion Series 311

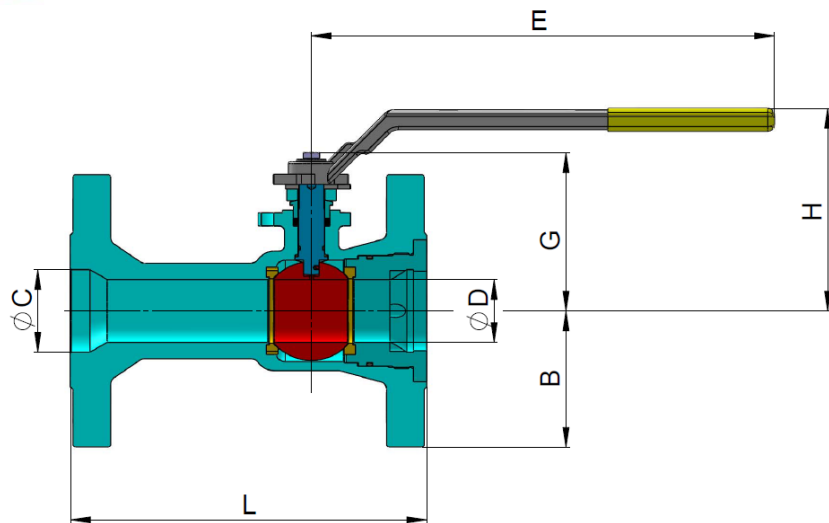
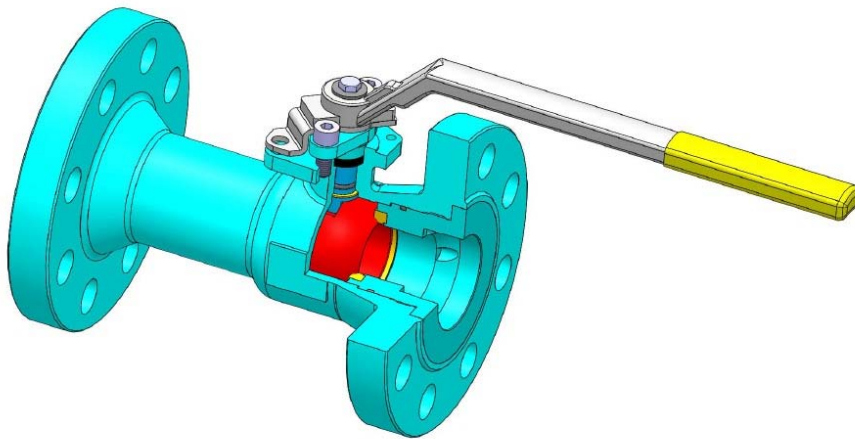

Weights and Dimensions:

SIZE	CLASS /	D	C	L	B	G	H	E	Cv	WEIGHT
In / DN	PN	In / mm	In / mm	In / mm	In / mm	In / mm	In / mm	In / mm	gal / min	Kg / Lbs
3/4 / 20	150 / 20	0.50 / 12.7	0.75 / 19.05	4.62 / 117	1.94 / 49	1.86 / 47	3.69 / 94	6.30 / 160	10	2.1 / 4.6
	300 / 50	0.50 / 12.7	0.75 / 19.05	6.00 / 152	2.31 / 59	1.86 / 47	3.69 / 94	6.30 / 160	10	3.1 / 6.8
1 / 25	150 / 20	0.75 / 19.05	1.00 / 25	5.00 / 127	2.13 / 54	2.22 / 57	3.98 / 101	6.30 / 160	27	2.9 / 6.4
	300 / 50	0.75 / 19.05	1.00 / 25	6.50 / 165	2.44 / 62	2.22 / 57	3.98 / 101	6.30 / 160	27	4.2 / 9.2
1-1/2 / 40	150 / 20	1.25 / 32	1.50 / 38.1	6.50 / 165	2.50 / 64	2.88 / 73	4.45 / 113	7.09 / 180	96	5.5 / 12.1
	300 / 50	1.25 / 32	1.50 / 38.1	7.50 / 190	3.06 / 78	2.88 / 73	4.45 / 113	7.09 / 180	96	8.5 / 18.7
2 / 50	150 / 20	1.50 / 38	2.00 / 50	7.00 / 178	2.99 / 76	3.72 / 94	4.68 / 119	11.02 / 280	110	8.5 / 18.7
	300 / 50	1.50 / 38	2.00 / 50	8.50 / 216	3.25 / 83	3.72 / 94	4.68 / 119	11.02 / 280	110	11.5 / 25.3
2-1/2 / 65	150 / 20	2.00 / 50	2.50 / 63.5	7.50 / 191	3.50 / 89	4.06 / 103	5.02 / 128	11.02 / 280	220	12.0 / 26.4
	300 / 50	2.00 / 50	2.50 / 63.5	9.50 / 241	3.74 / 95	4.06 / 103	5.02 / 128	11.02 / 280	220	15.5 / 34.1
3 / 80	150 / 20	2.50 / 63.5	3.00 / 76.2	8.00 / 203	3.76 / 96	5.02 / 128	6.09 / 155	14.17 / 360	390	16.0 / 35.2
	300 / 50	2.50 / 63.5	3.00 / 76.2	11.14 / 283	4.13 / 105	5.02 / 128	6.09 / 155	14.17 / 360	390	24.0 / 52.8
4 / 100	150 / 20	3.00 / 76.2	4.00 / 101.6	9.00 / 229	4.51 / 115	5.44 / 138	6.51 / 165	14.17 / 360	450	25.0 / 55
	300 / 50	3.00 / 76.2	4.00 / 101.6	12.00 / 305	5.00 / 127	5.51 / 140	6.51 / 165	14.17 / 360	450	37.0 / 81.4
6 / 150	150 / 20	3.94 / 100	6.00 / 152.4	10.50 / 267	5.49 / 140	7.26 / 185	7.83 / 199	17.72 / 450	640	45.0 / 99
	300 / 50	3.94 / 100	6.00 / 152.4	15.88 / 403	6.26 / 159	7.26 / 185	7.83 / 199	17.72 / 450	640	60.0 / 132
8 / 200	150 / 20	5.91 / 150	7.87 / 200	11.50 / 292	6.75 / 172	8.60 / 219	9.41 / 239	37.40 / 950	1650	75.0 / 165
	300 / 50	5.91 / 150	7.87 / 200	16.50 / 419	7.50 / 191	8.60 / 219	9.41 / 239	37.40 / 950	1650	95.0 / 209

Note: 1. "L" DIMENSION ±0.06in. /1.5mm

2.The End-to-End dimensions of Series311 are in short-pattern per ASME B16.10. where it is applicable





Crown - fusion Series 311

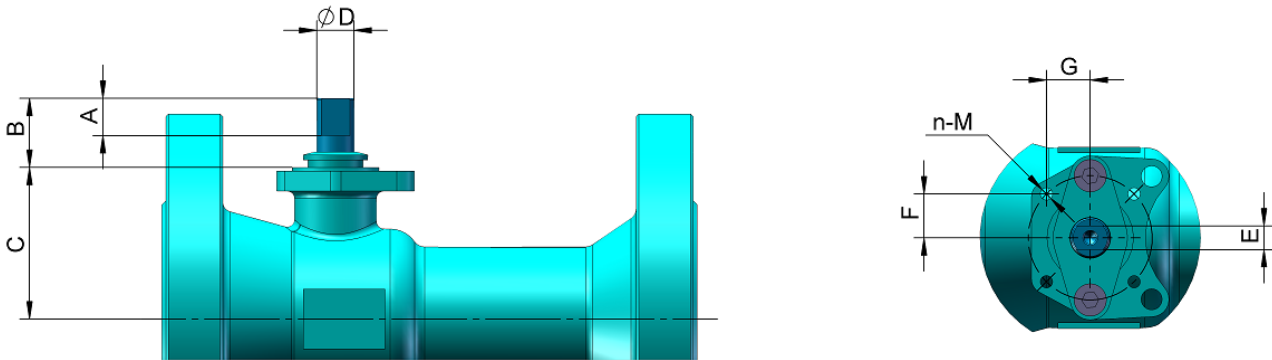

Actuator Mounting Dimensions:

SIZE	CLASS	BORE	A	B	C	D	E (FLAT)	F	G	n-M	ISO
In / DN			In / mm	In / mm	In / mm	In / mm	In / mm	In / mm	In / mm	mm	5211
3/4 / 20	150, 300, 600	RP	0.45 / 11.5	0.89 / 22.5	1.02 / 26	0.35 / 9	0.20 / 5	0.39 / 9.9	0.39 / 9.9	4-M5X5 DEEP	-
1 / 25	150, 300, 600	RP	0.45 / 11.5	0.89 / 22.5	1.28 / 32.5	0.35 / 9	0.20 / 5	0.50 / 12.7	0.50 / 12.7	4-M5X6 DEEP	F03
1 1/2 / 40	150, 300, 600	RP	0.57 / 14.5	1.08 / 27.5	1.77 / 45	0.43 / 11	0.24 / 6	0.58 / 14.8	0.58 / 14.8	4-M5	F04
2 / 50	150, 300, 600	RP	0.59 / 15	1.09 / 27.8	2.40 / 61	0.59 / 15	0.37 / 9.5	0.70 / 17.7	0.70 / 17.7	4-M6	F05
2 1/2 / 65	150, 300, 600	RP	0.59 / 15	1.09 / 27.6	2.76 / 70	0.59 / 15	0.37 / 9.5	0.70 / 17.7	0.70 / 17.7	4-M6	F05
3 / 80	150, 300	RP	0.81 / 20.5	1.55 / 39.3	3.19 / 81	0.71 / 18	0.47 / 12	0.97 / 24.8	0.97 / 24.8	4-M8	F07
	600	RP	0.81 / 20.5	1.63 / 41.5	3.50 / 89	0.87 / 22	0.59 / 15	0.97 / 24.8	0.97 / 24.8	4-M8X10 DEEP	F07
4 / 100	150	RP	0.81 / 20.5	1.52 / 38.6	3.62 / 92	0.71 / 18	0.47 / 12	0.97 / 24.8	0.97 / 24.8	4-M8	F07
	300	RP	0.81 / 20.5	1.53 / 38.8	3.62 / 92	0.87 / 22	0.59 / 15	0.97 / 24.8	0.97 / 24.8	4-M8	F07
6 / 150	150, 300	RP	1.10 / 28	2.01 / 51	4.84 / 123	1.42 / 36	0.94 / 24	1.42 / 36.1	1.42 / 36.1	4-M10	F10
	600	RP	1.10 / 28	2.09 / 53	5.16 / 131	1.42 / 36	0.94 / 24	1.42 / 36.1	1.42 / 36.1	4-M10X10 DEEP	F10
8 / 200	150, 300	RP	1.06 / 27	2.09 / 53	6.30 / 160	1.42 / 36	0.94 / 24	1.74 / 44.2	1.74 / 44.2	4-M12	F12

Due to continuous development of our products, we reserve the right to modify our product design or construction without prior notice.

